

HOLD-UP SWITCH

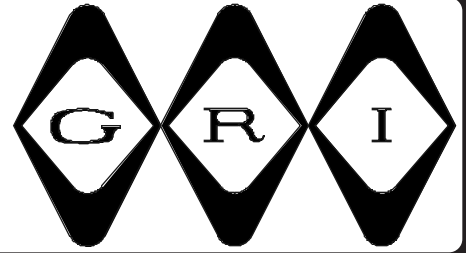

**Will Trip Alarm Even
When Operator Is
Wearing Gloves!!**

HD-1 Latching Circuit HD-2 Non-Latching Circuit

- ◆ Silent Operation
- ◆ No Moving Parts
- ◆ LED Indicates Armed State & Alarm Condition
- ◆ Low Profile

The G.R.I. Hold-Up Devices can be installed in fast food restaurants, banks, mini-marts, health care facilities, jewelry stores or any installation that calls for an absolutely silent emergency alarm. Their unique design features a glowing green LED to indicate an armed state. To insure against accidental tripping, both finger pads must be touched simultaneously. When this occurs, the LED glows red and the zone will go into an alarm condition. An accidental bump or touch will not trigger the G.R.I. Hold-Up Devices. A magnetic key is supplied for resetting the HD-1 latching model. C²T technology allows even an operator wearing gloves to activate sensor. Perfect Hold-Up Device for fast food restaurants.

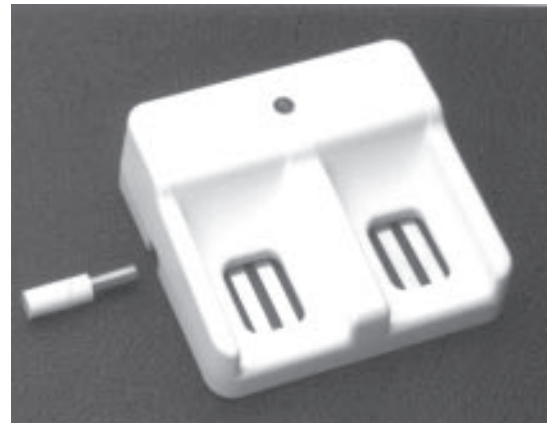

HD-1

Operation Parameters:

Normally Open, Normally Closed loop configurations.

12 volts DC required for operation at installation. (Other operating voltages available on request).

Silent operation, no moving parts.

Modern case design for installation above or below a counter or tabletop.

Easy installation: Hookup zone wires and mount on surface. Mounting screws included.

C Form Relay Contacts:

Carry Current	1.00 amp
Switch Current	0.25 amp
Contact Resistance	0.20 ohms
Operation Time	3.00 milliseconds

Power Requirements:

Voltage	7.5 - 18 volts DC (normal)
Current	40 milliamps

Case:

Injection Molded
Modern Design For Ease of Operation
No Sharp Corners
ABS Plastic For Durability

GEORGE RISK INDUSTRIES, INC.
G.R.I. PLAZA
KIMBALL, NE 69145



MADE IN U.S.A.

TOLL-FREE 1-800-445-5218
TOLL-FREE 1-800-523-1227
(308) 235-4645 • FAX (308) 235-3561
E-MAIL: grisales@megavision.com
WEB SITE: www.grisk.com

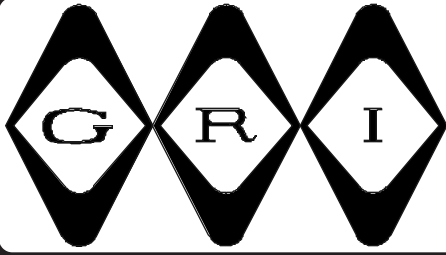

HOLD-UP SWITCH

G.R.I. HOLD-UP DEVICE INSTALLATION NOTES:

- 1) Drill a hole pattern as indicated using a #32 drill:

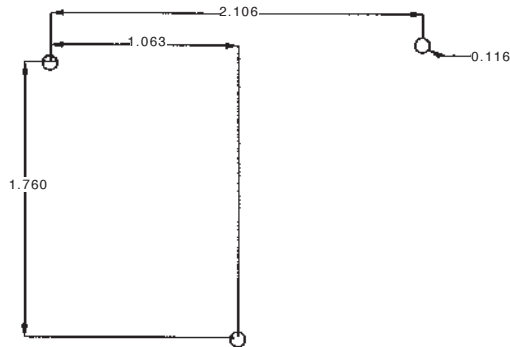

- 2) Connect power lines (+12 volts DC and Ground) to holdup terminal block. Then connect zone wires to Common and Normally Closed (N/C) and/or Normally Open (N/O) lines to security panel. When switch is active the N/C line is open and the N/O line is closed. The reverse is true after the switch has been tripped indicating an alarm condition.

Back

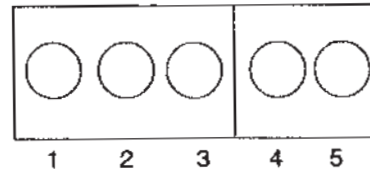

1-Common 2-N/C 3-N/O 4-Ground 5- +12volts

- 3) Mount unit base in desired position using the three, 3/4 inch pan head screws provided. Snap cover onto base.

- 4) Apply power to the unit. When installing the latching HD-1, you must reset the switch using the magnetic key supplied. The HD-1 will power up in the alarm condition and must be reset into the armed state. When installing the non-latching HD-2, this is not necessary. The armed state for both latching and non-latching hold-up devices is indicated by the green LED being illuminated.

When both pads are touched at the same time, the armed green light will go out and the zone will be put into an alarm condition indicated by the red LED.

The non-latching HD-2 unit will automatically reset once the pads are released.

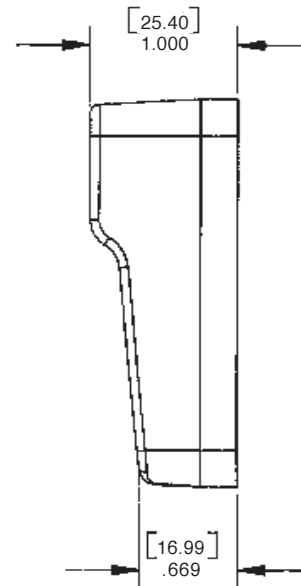
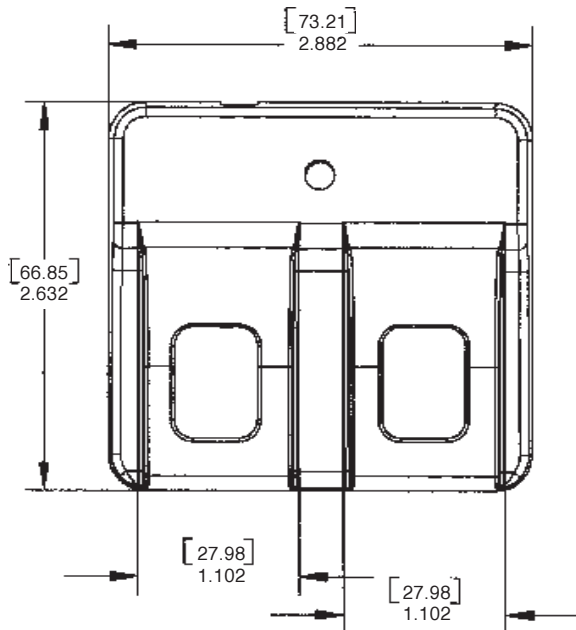

WARRANTY: One year warranty against workmanship, material and factory defects.

GEORGE RISK INDUSTRIES, INC.
G.R.I. PLAZA
KIMBALL, NE 69145



MADE IN U.S.A.

TOLL-FREE 1-800-445-5218
TOLL-FREE 1-800-523-1227
(308) 235-4645 • FAX (308) 235-3561
E-MAIL: grisales@megavision.com
WEB SITE: www.grisk.com