

PUSH BUTTON/ PLUNGER

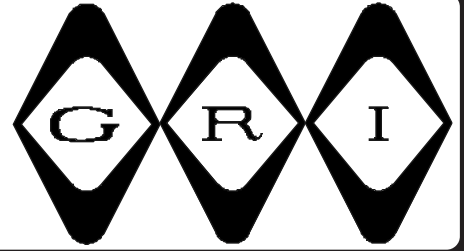

PB/PBF SERIES



- ◆ Recessed Magnetic Contact
- ◆ PB is 9/16" Press Fit ◆ PBF is 3/4" x 1 1/2" With Screw Down Flange
 - ◆ 12" #22AWG Leads or Screw Terminals
 - ◆ Longer Leads, Zip Cord or Jacketed Cable Upon Request
- ◆ Hermetically Sealed ◆ Plated Contacts Resist Sticking or Freezing
 - ◆ Spacers and Mounting Hardware Included
- ◆ Built-in E.O.L Resistors and Diodes Upon Request
- ◆ Colors: White, Brown ◆ Lifetime Warranty



PB-100



PBF-100



PB-100T



PBF-100T

PART NUMBERS:

| | Closed Loop | Open Loop | SPDT |
|----------------|---------------------------|---------------------|-------------|
| Without Flange | PB-100 PB-100T | PB-101 PB-101T | PB-102 |
| With Flange | PBF-100 PBF-100T | PBF-101 PBF-101T | PBF-102 |
| Travel: | Total .270 | | |
| | Pre Travel .090 ± .040 | | |

GEORGE RISK INDUSTRIES, INC.
G.R.I. PLAZA
KIMBALL, NE 69145



MADE IN U.S.A.

TOLL-FREE 1-800-445-5218
TOLL-FREE 1-800-523-1227
(308) 235-4645
FAX (308) 235-3561
E-MAIL: grisales@megavision.com
WEB SITE: www.grisk.com

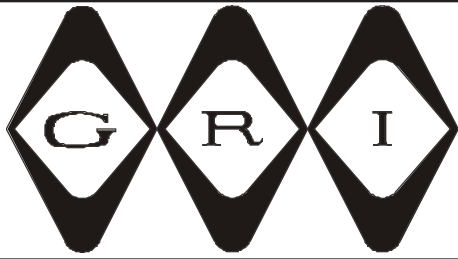

PUSH BUTTON/ PLUNGER

INSTALLATION APPLICATIONS:

The Push Button or Plunger actuated PB series was developed as a direct replacement of an existing and problematic mechanical type contact. The PBF flange push button can be installed without re-drilling or redesigning the original installation. The sealed contacts of the reed switch insure a long service life. Plunger actuated reed switches have become so popular on new installations that many variations are now being produced. The PB-100 is a press fit design and eliminates the screw mounted flange. A terminal connection is offered on most models and this option can be added by including a T at the end of the part number — for example PB-100T.

Important Note: G.R.I.'s push button contacts are not recommended for the bottom track of windows or doors.

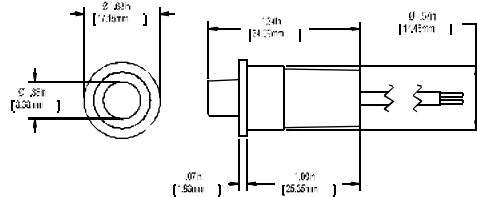

PB-100

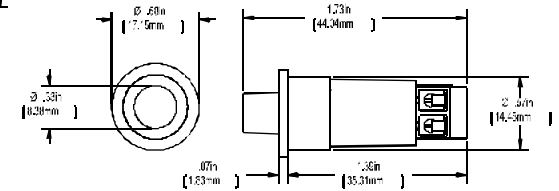

PB-100T

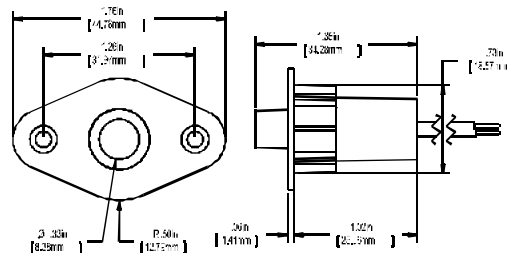

PBF-100

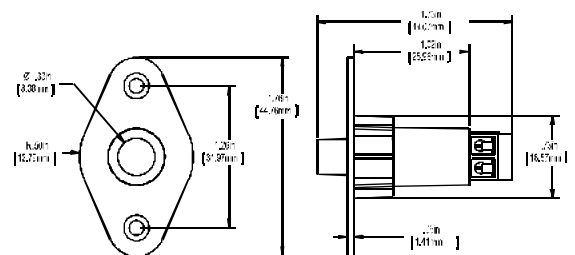

GRI products meet or exceed these minimum general specifications:

| PART NUMBER | LOOP TYPE | ELECTRICAL CONFIG. | REED FORM | MAXIMUM INITIAL CONTACT RESISTANCE (Ω) | MAXIMUM CONTACT RATING (W) | MAXIMUM SWITCHING VOLTAGE (VDC/VAC) | MAXIMUM SWITCHING CURRENT (A) |
|-------------|-------------|--------------------|-----------|--|----------------------------|-------------------------------------|-------------------------------|
| PB-100 | Closed | N/O | A | .150 | 10 | 200/140 | .500 |
| PB-100T | Closed | N/O | A | .150 | 10 | 200/140 | .500 |
| PBF-100 | Closed | N/O | A | .150 | 10 | 200/140 | .500 |
| PBF-100T | Closed | N/O | A | .150 | 10 | 200/140 | .500 |
| PB-101 | Open | N/C | B | .140 | 5 | 175VDC | .250 |
| PB-101T | Open | N/C | B | .140 | 5 | 175VDC | .250 |
| PBF-101 | Open | N/C | B | .140 | 5 | 175VDC | .250 |
| PBF-101T | Open | N/C | B | .140 | 5 | 175VDC | .250 |
| PB-102 | Open/Closed | SPDT | C | .140 | 5 | 175VDC | .250 |
| PBF-102 | Open/Closed | SPDT | C | .140 | 5 | 175VDC | .250 |

PBF-100T

WARRANTY:

Lifetime warranty against workmanship, material and factory defects.

CONTACT YOUR G.R.I. DISTRIBUTOR OR CALL:

GEORGE RISK INDUSTRIES, INC.
G.R.I. PLAZA
KIMBALL, NE 69145



MADE IN U.S.A.

TOLL-FREE 1-800-445-5218

TOLL-FREE 1-800-523-1227

(308) 235-4645

FAX (308) 235-3561

E-MAIL: grisales@megavision.com

WEB SITE: www.grisk.com